

### Products

- CCTV
- Access Control
- ANPR
- Visitor Management
- Panic Alarm Systems
- Interview Recording

### Markets

- Marine
- Oil & Gas
- Law Enforcement
- Parking
- Security



## Marine Bullet Camera - Stainless Steel

FIXED

BHOS2F4II66M

This compact camera provides a fixed angle view in 2MP HD video. It is housed in a heavy-duty, stainless steel, weatherproof enclosure suitable for hostile environments. It is ready for mounting, requiring only power and an IP connection. A wall mount arm is provided. Other mounting options are available. It can be used in Marine and Offshore environments. For example, passenger ships, bridges and engine rooms. It offers a choice of lenses/viewing angles. It's small volume and light weight makes it particularly suitable for applications where a small form factor is required.

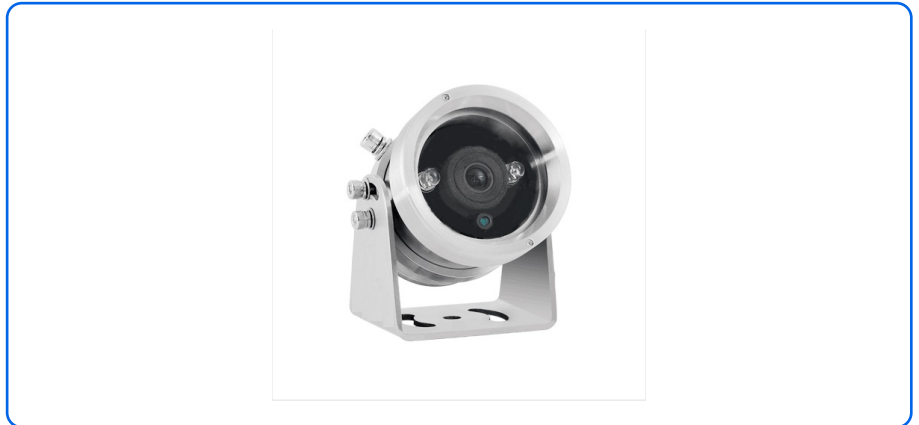

### Features

- Marine 316L grade stainless steel
- Fixed lens - 4/6mm options
- Support ONVIF, HIKVISION, DAHUA
- Suited to strong corrosive environments. Anti-corrosion, waterproof.
- Uses SONY1/3"CMOS Sensor
- High quality IR lamp , long service life , low power consumption. Distance up to 15 meters
- Windows glass surface process by nano technology . Good light transmittance.
- Anti-shock engineering technology
- 2MP resolution
- Suited to harsh environmental conditions including petrochemicals, mining, military, medicine, oil & gas, marine, drilling platforms, food processing and storage, offshore etc.

### Products

- CCTV
- Access Control
- ANPR
- Visitor Management
- Panic Alarm Systems
- Interview Recording

### Markets

- Marine
- Oil & Gas
- Law Enforcement
- Parking
- Security

## Technical Specifications

### BHOS2F4I166M

Sensor	SONY 1/2.7"CMOS
Resolution	2MP
Pixels	1920×1080
Frame rate	1 to 25 fps - adjustable
Sensitivity	Colour 0.1Lux@F1.2,BW0.01 Lux@F1.2;
Optical Lens	4mm、6mm options
IR Illumination range	15m @ 850nm
Image features	Rotate mode, Saturation, Brightness, Contrast adjustable by client software or web browser
Video compression	H.264/H.265/MJPEG
Bitrate	32 Kbps~8Mbps
Support protocols	RTSP/FTP/PPPOE/DHCP/DDNS/NTP/UPnP etc
Interface protocols	ONVIF,PSIA,CGI,ISAPI,GB28181
Alarms	Optional
Audio compression	Base Line Profile / Main Profile
Ethernet	Ethernet RJ-45(10/100/1000Base-T)
Power supply	DC12V/POE(Optional)
Ingress protection	IP66
Material	316L stainless steel
Operating temp	-40°C~60°C
Relative humidity	≤ 95% (+25°C)
Atmospheric pressure	80kpa~106 kpa
Dimensions - external (mm)	Dia 83 117L 110H
Cable entry	1pcs M20*1.5 output(original G1/2)
Mounting options	Wall hanging, fixed bracket , pedestal base

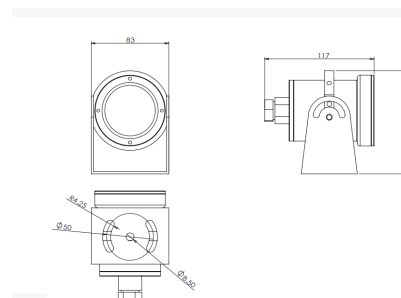

For more information on any of our products or services please contact:

#### Paragon Security Limited

Unit 14, Bentalls Business Park, Colchester Road, Maldon, Essex CM9 4GD UK

+44 (0)1245 210914

info@paragon-security.com

paragon-security.com